



The SafeLink® I/O S-Nodes™ provide your electrical system with the flexibility you demand.

Key Features & Benefits

- Fully configurable with the SafeLink Integrated Development Environment (IDE) by the OEM.
- OEM connects to one or all nodes with the IDE, to run in debug mode and monitor I/O and all memory in real-time.
- Endless features and options to help the OEM meet the demands of highly custom fleets and one-off vehicles.
- 150A total continuous power with high current and low current outputs for maximum flexibility.
- 28 total inputs {24 digital, 4 analog} Digital inputs have debounce and wetting current settings by the OEM
- 36 total outputs (32 hi and 4 low) have under current and over current settings by the OEM
- IP67, -40° to +85°C



www.fireresearch.com
631.724.8888
sales@fireresearch.com



Specifications

Node Data	
Operating Voltage	8VDC to 32VDC. Reverse polarity protection on power
Operating Temperature	-40F to 185F (-40C to +185C)
CAN Network	125, 250 or 500KBS, peer to peer
Sealed Enclosure	IP67, Deutsch Connectors
Dimensions	13.9" x 8" x 2.5"
Weight	6.2lbs

Inputs/Outputs	
24 Digital Inputs	16 Bi-Directional and 8 Ground only.
4 Analog Inputs	4-20 mA, 0-5VDC, 0-VBAT, resistive or use as a digital input
36 Digital Outputs	4-25amp, 4-15amp, 8-8amp, 16-4amp, and 4 low side at 4amp
2 CAN Ports	1 SI-CAN and 1 configurable port
1 Micro USB OTG	For connecting to node or flashing
Memory	1MB Flash, 320KB SRAM,

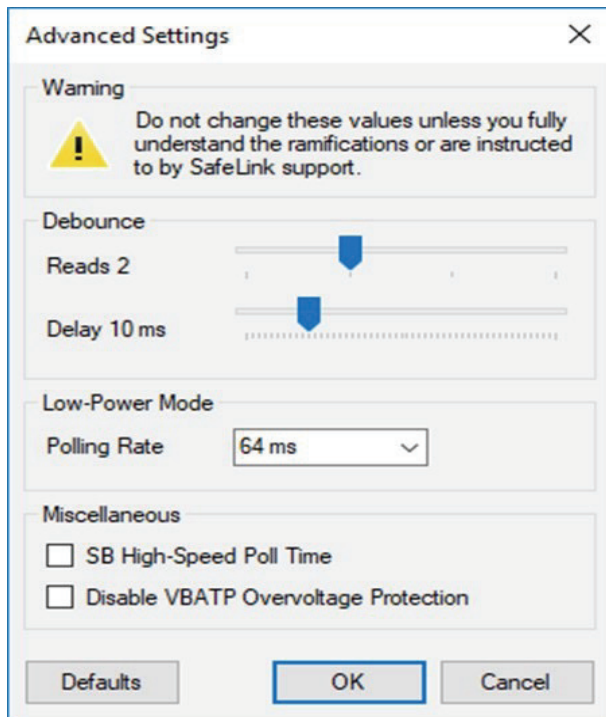

Inputs

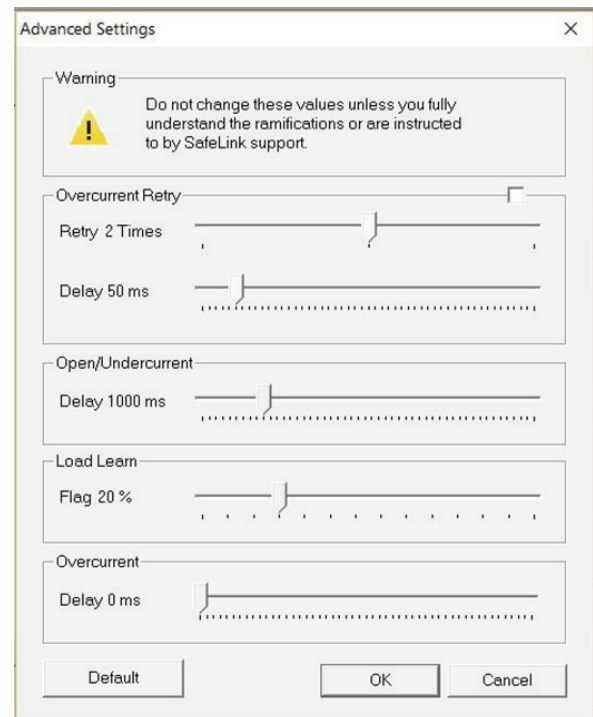

Outputs

Advanced I/O